

[www.visionaryhomes.com](http://www.visionaryhomes.com)

## Mead

2 Elevations Available

 1,714 Total Sq.Ft.

 3 Bedrooms

 2.5 Bathrooms

 2 Car Garage

Introducing the Mead 2-story townhome, offering 3 bedrooms and 2.5 bathrooms. The main floor features an open concept with a family room, dining area, and kitchen that boasts a walk-in pantry and island. At the back of the home you'll find access to the 2 car garage that provides essential covered parking and additional storage solutions. On the second level, a loft provides versatile space, alongside a laundry room and guest bathroom. Two guest bedrooms and the primary suite with a generous walk-in closet complete the second level. Throughout the townhome you'll enjoy features like granite countertops, white soft-close cabinets, stainless steel appliances, and smart home features.



\*Visionary Homes reserves the right to change prices without notice. Approximate square footage and options shown in plan may not be included in base price.

**435.228.4702**  
[visionaryhomes.com](http://visionaryhomes.com)





www.visionaryhomes.com

MAIN LEVEL - SLAB ON GRADE



\*Visionary Homes reserves the right to change prices without notice. Approximate square footage and options shown in plan may not be included in base price.



www.visionaryhomes.com

UPPER LEVEL

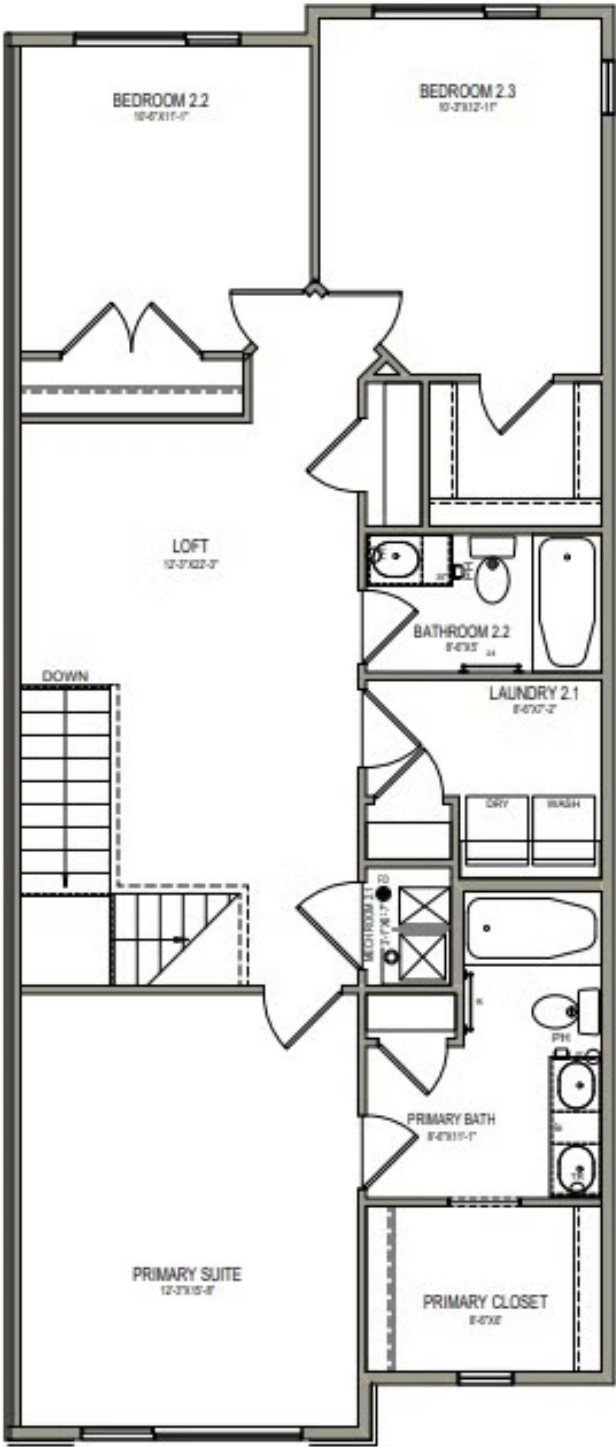

\*Visionary Homes reserves the right to change prices without notice. Approximate square footage and options shown in plan may not be included in base price.