

www.visionaryhomes.com



Cortez

3 Elevations Available

 1,386 Total Sq.Ft.

 3 Bedrooms

 2.5 Bathrooms

 2 Car Garage

The Cortez townhome offers a perfect blend of comfort and functionality, featuring two bedrooms, two and a half bathrooms across two levels, and an attached garage. The main level boasts an open-concept design with a spacious great room that flows into the dining and kitchen area, complete with a central island and pantry, while a convenient half bath and direct access to the two-car garage enhance functionality. Upstairs, the primary suite features a generous bedroom, a walk-in closet, and an ensuite with dual sinks, complemented by two additional bedrooms, a shared full bath, and a versatile loft space; ideal for a home office or lounge. A dedicated laundry room on the upper level ensures convenience, making this thoughtfully designed home perfect for modern living.



*Visionary Homes reserves the right to change prices without notice. Approximate square footage and options shown in plan may not be included in base price.

435.228.4702
visionaryhomes.com



www.visionaryhomes.com

MAIN LEVEL - SLAB ON GRADE

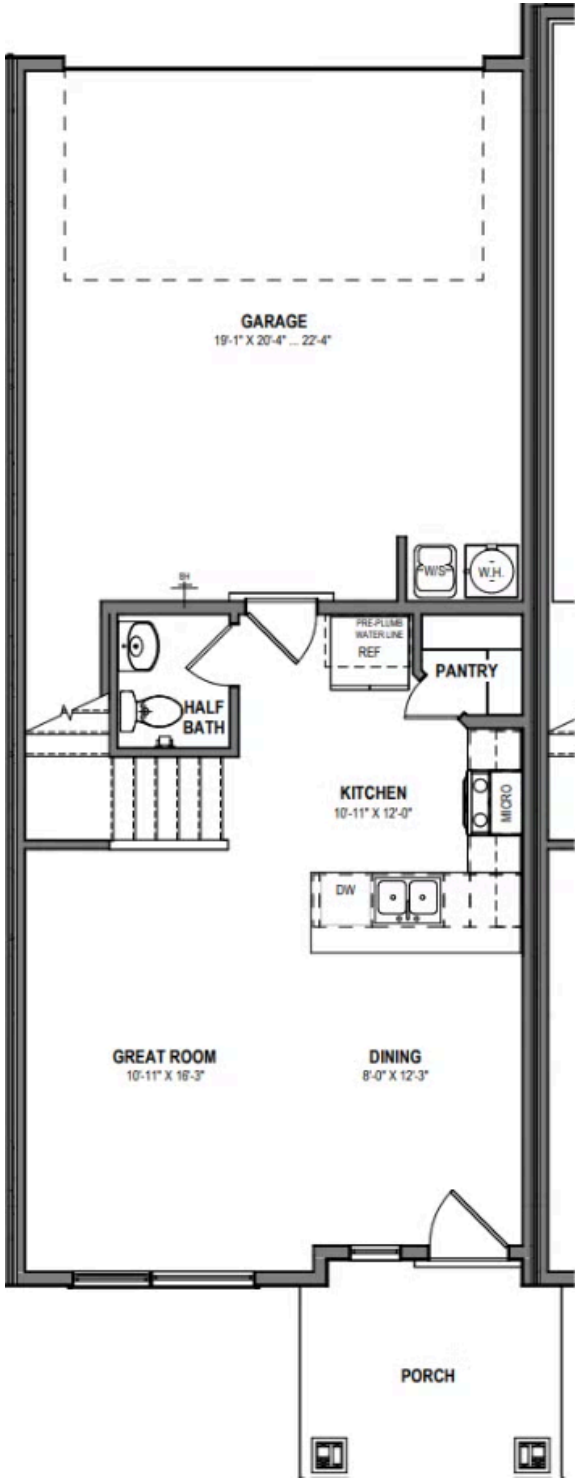

*Visionary Homes reserves the right to change prices without notice. Approximate square footage and options shown in plan may not be included in base price.

www.visionaryhomes.com

UPPER LEVEL

